

# Vehicle Information

Make and model **Toyota Highlander 4WD**

Engine size 3.5L Petrol

## How to unlock the vehicle

► Vehicles with a smart key system

① Locks all the doors

Check that the door is securely locked.

② Unlocks all the doors

Pressing the button unlocks the driver's door. Pressing the button again within 5 seconds unlocks the other doors.

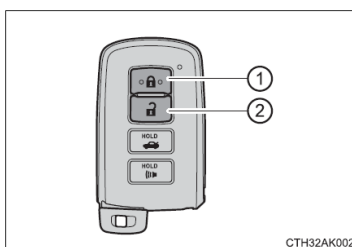

## How to start the vehicle

Performing the following operations when carrying the electronic key on your person starts the engine or changes engine switch modes.

- 1 Check that the parking brake is set.
- 2 Check that the shift lever is set in P.
- 3 Firmly depress the brake pedal.



and a message will be displayed on the multi-information display. If it is not displayed, the engine cannot be started.

- 4 Press the engine switch shortly and firmly.

When operating the engine switch, one short, firm press is enough. It is not necessary to press and hold the switch.

The engine will crank until it starts or for up to 30 seconds, whichever is less.

Continue depressing the brake pedal until the engine is completely started.

The engine can be started from any engine switch mode.

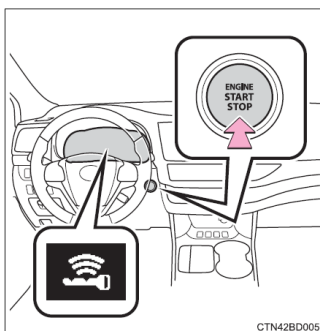

## How to put the vehicle into reverse

### “R” REVERSE

Move the lever to this position only after the vehicle has come to a complete stop.

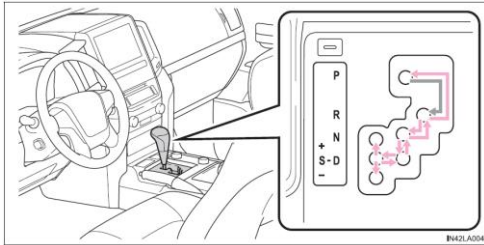

← While the engine switch is in IGNITION ON mode, move the shift lever with the brake pedal depressed.  
When shifting the shift lever between P and D, make sure that the vehicle is completely stopped.

Shift position	Purpose and condition
P	Parking the vehicle/starting the engine
R	Reversing
N	Neutral (Condition in which the power is not transmitted)
D	Normal driving <sup>*1</sup>

## Rear luggage compartment release

Press and hold the switch to open or close the back door, when the back door is unlocked.

Pressing the switch while the back door is opening/closing stops the operation.

To operate the back door again, press and hold the switch. The back door will then move in the opposite direction.

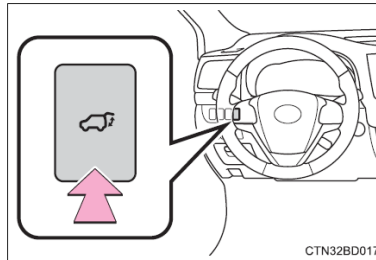

## Park brake use

To set the parking brake, fully depress the parking brake pedal with your left foot while depressing the brake pedal with your right foot.

(Depressing the pedal again releases the parking brake.)

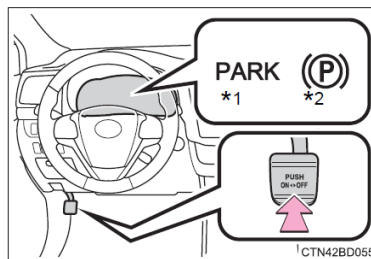

## Where the fuel release is

- 1 Press the opener switch.

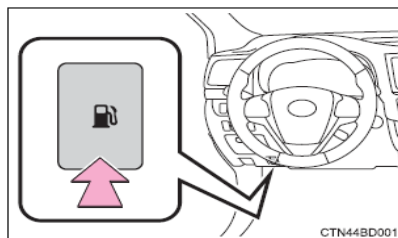

- 2 Turn the fuel tank cap slowly to remove it and hang it on the back of the fuel filler door.

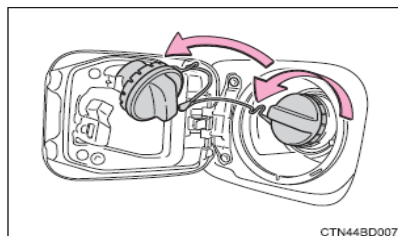

## What type of fuel does the vehicle take?

### Fuel selection

N00301002004

Your vehicle is designed to use unleaded gasoline only. It is equipped with a fuel tank filler pipe specifically designed to accept only a small diameter unleaded gasoline dispensing nozzle.

### ⚠ WARNING

- Gasoline is highly flammable and explosive. You could be burned, seriously injured or killed when handling it. Whenever you refuel your vehicle, stop the engine and keep flames, sparks, and smoking materials away from the vehicle. Always handle fuel in well-ventilated outdoor areas.

## Spare tyre position and where you will find the jack

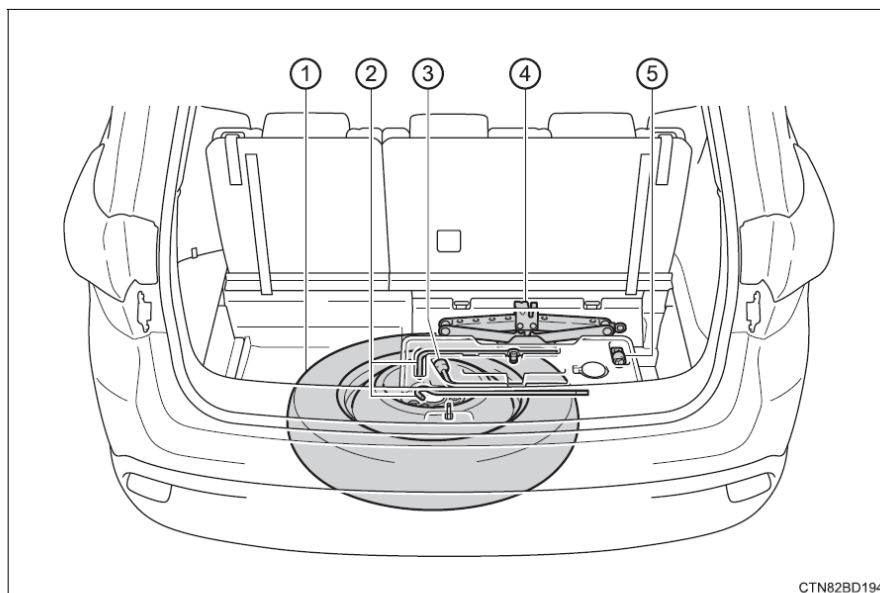

- 1 Spare tire
- 2 Jack handles
- 3 Wheel nut wrench
- 4 Jack
- 5 Adapter socket

## **Does the car have Bluetooth?**

Yes – all you need to do is connect your phone to the car this works for Apple or Android

## **How to connect your mobile to Bluetooth?**

To connect your smartphone to Bluetooth®, just press the phone button on the stereo control panel, search for device manager and register the phone. Then on your phone, turn on Bluetooth® and it will show you a list of nearby devices you can pair with.